

外形寸法  
 Outline dimensions

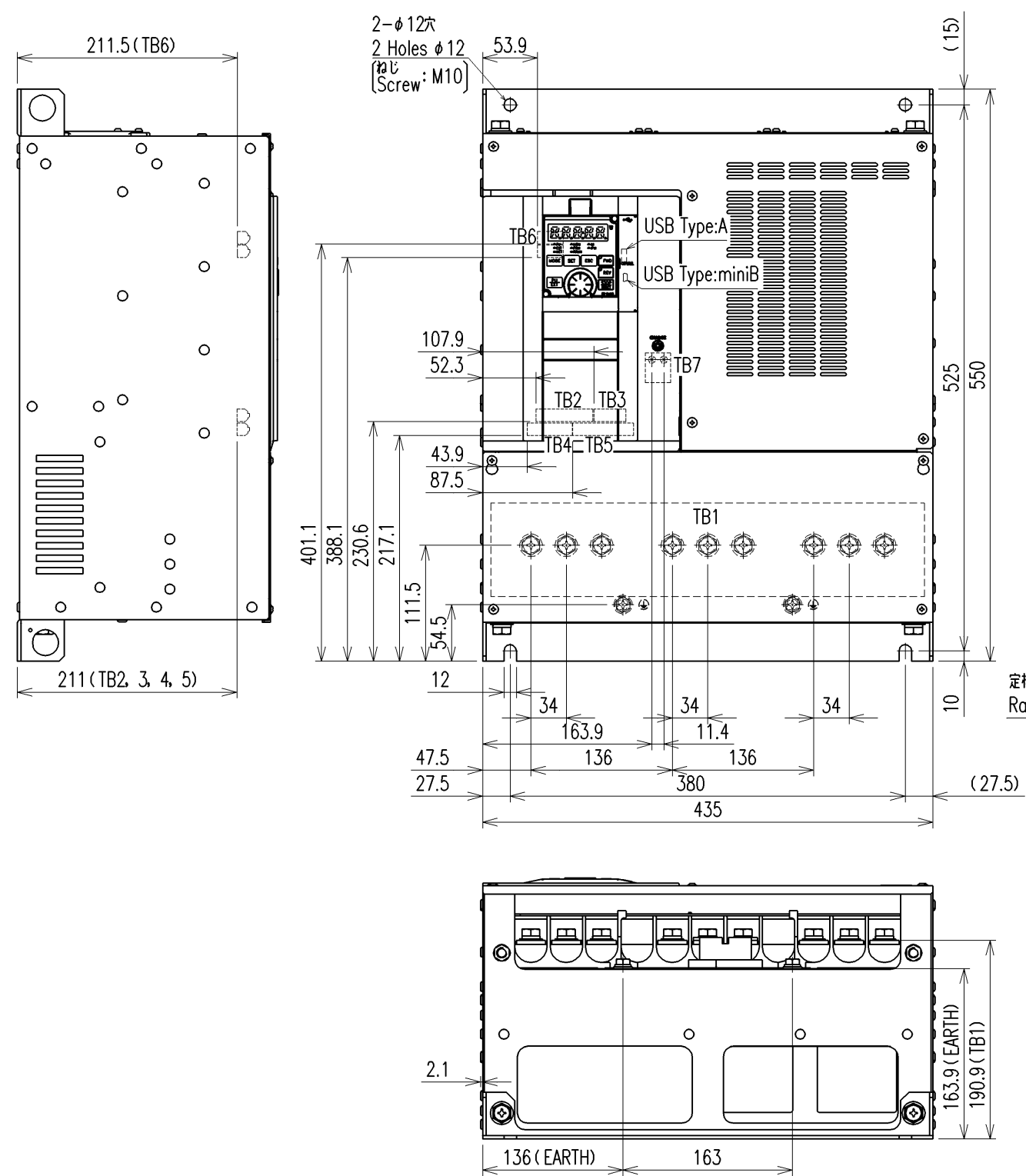

端子配列  
 Terminal arrangement

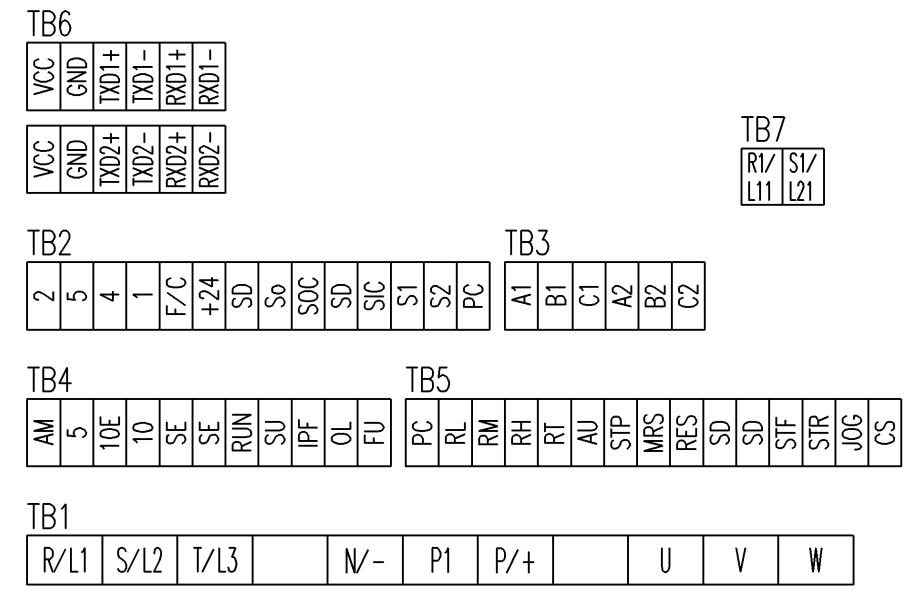

端子ねじサイズ  
 Terminal screw size

TB1	TB2, 3, 4, 5, 6	TB7	⊕
M10	-	M4	M8

TB2, 3, 4, 5, 6: スプリングクランプ端子台  
 Spring clamp terminal block  
 電線サイズ 0.3~0.75mm<sup>2</sup>  
 Wire size AWG 22~18

操作パネルキー配列  
 OPERATION PANEL key arrangement

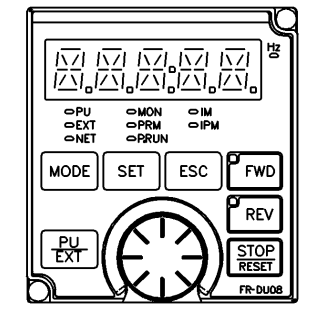

質量  
 Mass

42kg

寸法単位  
 DIM.IN :mm